

Tool description

When equipped with the correct blade and the speed controller set to the correct speed, the Proxxon micro bandsaw can cut steel, non-ferrous metal, wood and plastic.

General tool safety**PPE**

Always wear eye protection.

Wear a dust mask where appropriate

Wear hearing protection where appropriate

DO NOT wear gloves

Personal Safety

Do not wear loose clothing.

Remove Jewellery.

Keep hair tied up.

Do not overreach. Keep proper footing and balance at all times. This enables better control of the tool in unexpected situations.

Consider those working around you, inform them before starting the equipment so they can use relevant PPE, ensure there are no trip hazards.

Do not use a power tool while tired or rushed. A moment of inattention and incorrect use of PPE while operating power tools may result in serious personal injury and or death.

Dust extraction, ensure this is connected and properly used. Use of dust collection can reduce dust-related hazards.

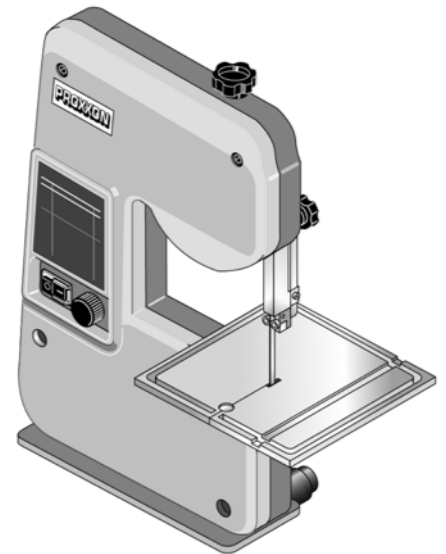
**Power Tool Use & Care**

Do not force the power tool. Especially round corners, this can snap the bandsaw blade, take it slow.

Correct settings will do the job better and more safely at the rate for which it is designed.

Do not use the power tool if the switch does not turn it on and off. Any power tool that cannot be controlled with the switch is dangerous and must be brought to the attention of a technician before further use.

Disconnect the plug from the power source before making any adjustments, changing accessories, or storing the tool. This will reduce the risk of starting the tool accidentally.

Visual bade inspection. With the saw unplugged, inspect the blade. Always check the saw blade to make sure it does not have missing teeth or is bent. Do not use a damaged saw blade. bring

this to the attention of a technician before continuing. Properly maintained tools with sharp cutting edges are less likely to bind and are easier to control. You may need to hold the back of the blade and pull it down gently to inspect the whole length.

Check material condition before cutting. Remove any foreign objects such as nails or screws from the material to prevent damaging the tool and its cutting blade. Do not use green or wet wood as the water and sap content can damage the tool and its cutters.

Cutting Shapes. This saw will allow you to cut more elaborate shapes compared to the larger workshop band saw but it is limited, too much twisting on the blade will result in the blade snapping, consider using hand tools such as coping saws.

Make adjustments to the positioning of the blade guard

Adjust and lock the blade guard in place so that it is positioned just above the workpiece allowing it to pass freely under the guard. Excess Blade exposure is unnecessary and dangerous

Guard lock (1)

Guard (2)

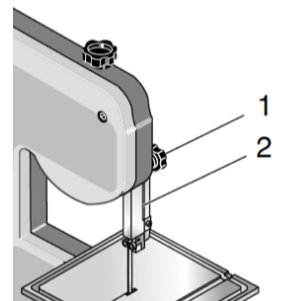

DO NOT adjust any other wheels or levers on this machine. If so, speak with a technician before further use of the machine.

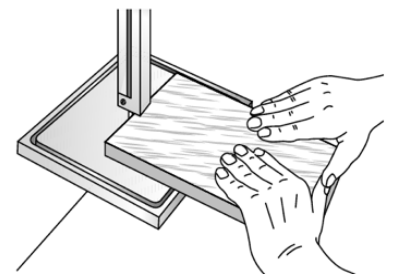

Push Sticks, Angle stops & Fence guides

When appropriate use push sticks and angle guides to guide the workpiece through the saw. This is commonly when the guide fence is set close to the Fence guide creating a small gap. The push stick is a tool that is used to keep your hands away from the blade.

Never place your hands or any other body part in front of the blade, even when the guard is correctly adjusted. Use the guard as a guide that your hands should be either side of the guard, approx. 25mm either side of the blade.

Never adjust anything whilst the machine is running. Allow the machine to come to a natural stop before making any adjustments to the guard or fence.

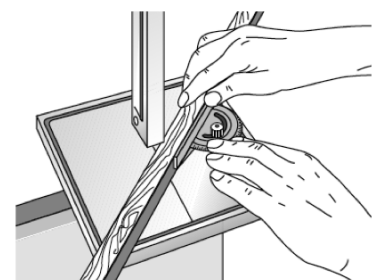
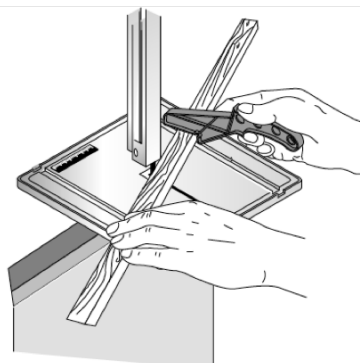

On Off & Speed

The band saw is turned On and Off using the switch (4)

The speed is adjusted using the knob (3)

A table is provided on the saw referencing the correct speed to the material being used (5)

DO NOT force the material into the blade. Allow the machine and blade to do the work.

DO NOT turn on the band saw whilst the blade is touching the material, or turn off the bandsaw when you are half-way through cutting

Blade Breakage, if the blade breaks or becomes dislodged, turn off the machine, step back and notify a technician.

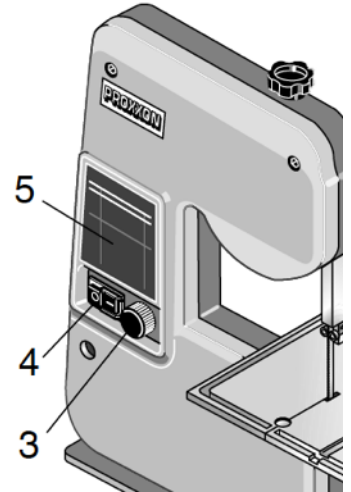

Extraction

Extraction will automatically start once the saw has been turned on.

When cutting **woods and plastics** ensure the extraction **IS** connected.

When cutting **metal** ensure the extraction **IS NOT** connected by removing the extraction hose is removed.

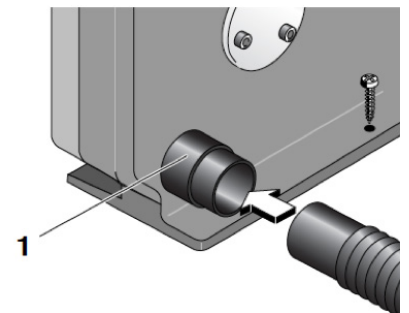

Miter cuts

For miter cuts, the work table can be tilted from 0° to 45°.

1. Release the clamping screw (1) and tilt the work table to the required
2. Read the graduated number on the scale 2.
3. Tighten the clamping screw 1. Make sure the table is stable before cutting.

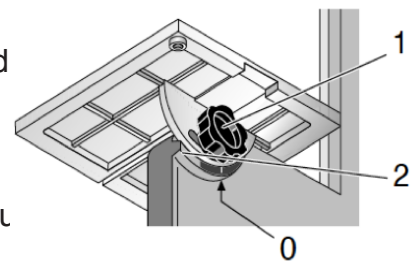

House keeping

Before starting any cleaning, disconnect the saw from the power supply.

The saw should be cleaned after every use. Use a vacuum with the brush attachment for the outside of the tool.

Never use compressed air to clean the tool. This will cause dust to be pushed into the atmosphere for you and others to breathe in as well as force dust into the motor and fixings of the tool.